

## Table of Contents

Purina Event Center Amenities . . . . . 2

Purina Event Center First Floor Layout . . . . . 3

Gateway Hall 5x10 Grooming Layout . . . . . 4

Agility Equipment List . . . . . 5

Purina Event Center Second Floor Layout . . . . . 6

Service Center Layout. . . . . 7

Space Details. . . . . 8

RV Layout. . . . . 9

Rules . . . . . 10

Emergency Procedures and Contacts . . . . . 13

Purina Farms Outdoor Canine Competition Venues . . . . . 16

Local Dog-Friendly Lodging . . . . . 17

Added Offerings . . . . . 18

Purina Farms Property Map . . . . . 19

Event Center Checklist for Shows . . . . . 20

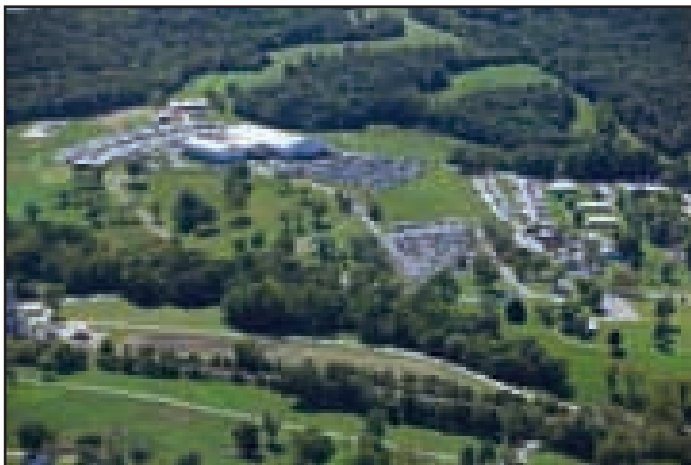

<b>Purina Event Center</b>																			
The Great Hall (150' x 300')																			
	Textured, rubber-padded permanent flooring suitable for conformation, obedience and agility trials																		
	Electric for vendors with additional electric available for grooming if necessary																		
	Loading and unloading areas																		
	1500 ft of ring gating, 25+ - 6' tables, 200+ chairs, 3 full sets of agility equipment, 1 Rally set and 4 full sets of Obedience Equipment																		
	150 ft of black pipe & drape																		
	90'x120' temporary artificial turf flooring for performance events (upon request)																		
	Up to 100 additional grooming spots with electric																		
Gateway Hall (150' x 90')																			
	150+ grooming spaces with easy access to electric																		
	Hall can be rented for smaller shows with multipurpose set-up																		
	Several points of entry for easy loading in & out																		
	6 dog bathing tubs and two sinks																		
	Exhibitor changing rooms with full-length mirrors and benches																		
	Public x-pen area adjacent to the Gateway Hall																		
Checkerboard Café																			
Show office	PA system and storage																		
Pro Plan Hospitality	Off of the Great Hall reserved for Pro Club members																		
Club Storage Room	Secure room for storing trophies, ribbons, catalogs, clothing, etc..																		
Founder's Room (Banquet Area on 2nd floor) (80' x 75')																			
	Accommodates 300+ guest at circular banquet tables and chairs																		
	Overlooks both the Great Hall and Gateway Halls																		
	Sound system, podium and projector with screen																		
Large Conference Room (2nd floor)(25' x 25')																			
	Accommodates 30+ people																		
	Overlooks the Great Hall																		
Service Center (East side of Center)																			
	Dog bathing tubs for RV visitors																		
	Shower and Restroom Facilities																		
	Conference Room																		
	Eye & Ear Exam Room																		
	Hospitality area with kitchenette																		
	50x70 off-leash exercise area																		
Outdoor Amenities/Parking																			
	74 full service RV hook-ups south of the Center (water, sewer & 50 amp service)																		
	Overflow RV lots for 45 RVs (water & 50 amp service)																		
	230 vehicle parking lot north of the Center with overflow into Visitor's Center main lot																		
	Unloading and loading lanes on North and South sides of Center with easy access to the facility																		
<i>Other items to note:</i> elevator access to 2nd floor, balcony viewing of the Great Hall, zoned sound system throughout facility, temperature controlled and wireless inside and outside the building in the RV lot																			

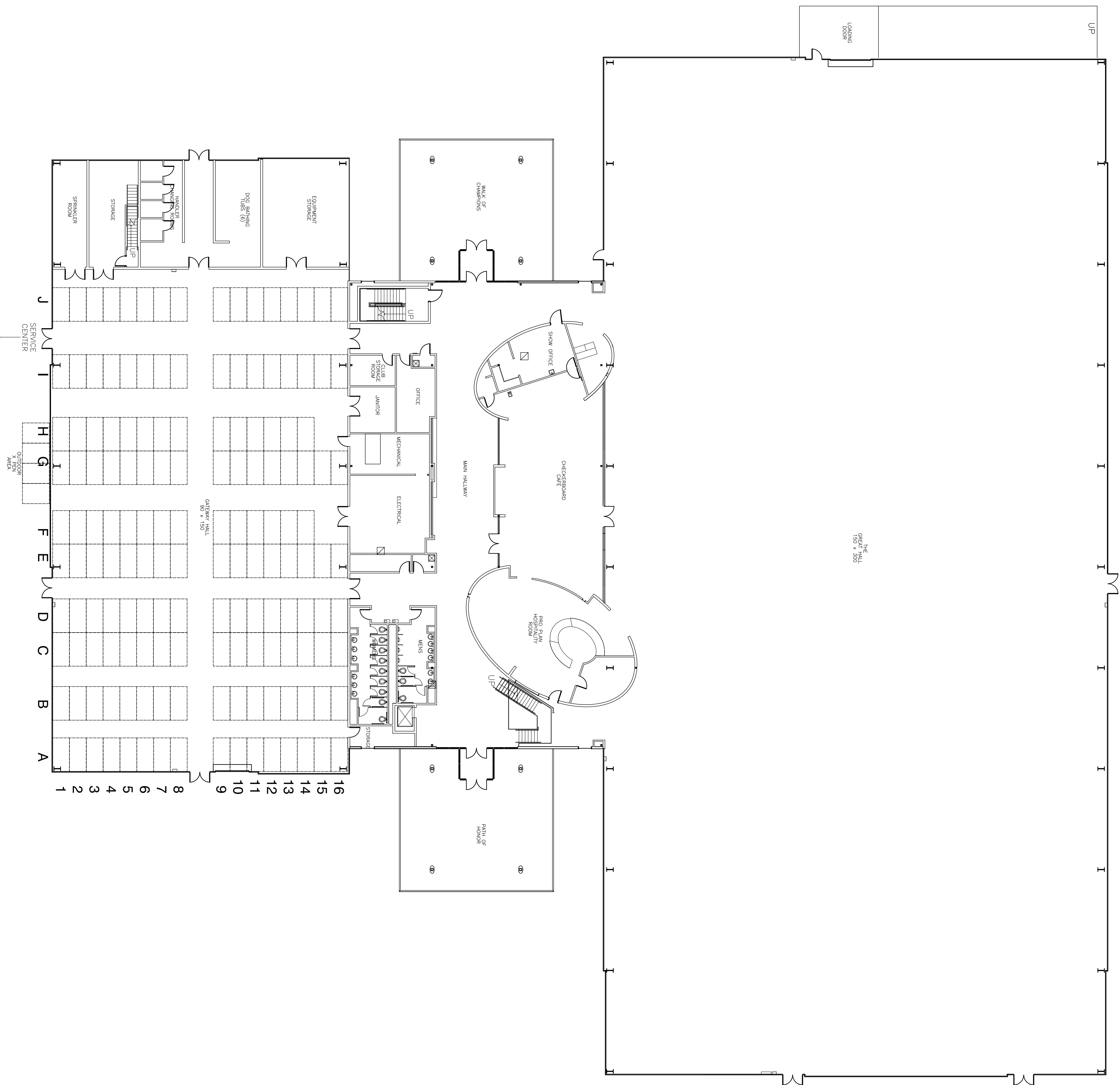

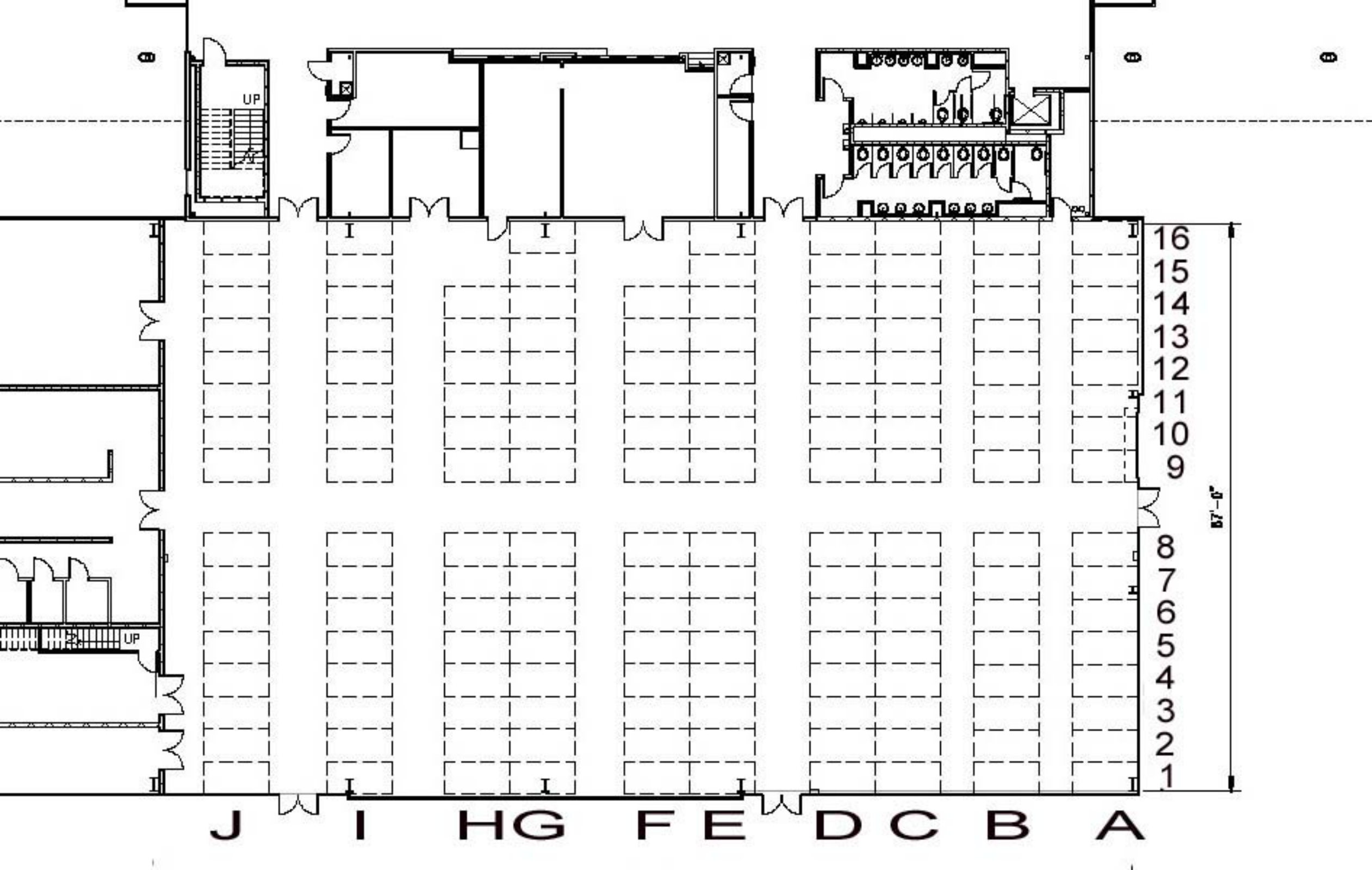

PURINA EVENT CENTER AGILITY EQUIPMENT		
Obstacle	Ring 1	Ring 2
A-Frame - Rubber Surface (adjustable to 5', 5'6" & 5' 11")	1	1
Dog Walk - Rubber Surface - 42" & 36" Contact Zones	1	1
Teeter - Rubber Surface - 42" & 36" Contact Zones	1	1
Pause Table - Rubber Surface - 8", 12", 16" & 24"	1	1
Tire - 20" Breakaway & 24" Regular Tires	1	1
Broad Jump or Long Jump	1	1
Chute (12' overall with fabric and barrel - can be adjusted to 9' overall) - 10' Chute Fabric also available	1	1
Weave Poles - 24" - can be 6 or 12	1	1
Tunnels - Two 20' & Two 15' (3 tunnel braces with weights for each tunnel)	3	3
Jumps - Triple with or without wings - 5' Bars with 18" Wings	1	1
Jumps - Double with or without wings - 5' Bars with 18" Wings	1	1
Jumps - Wing - 4' Bars with 18" Wings	9	12
Jumps - Nonwing - 4' Bars with 18" Wings	9	12
Jumps - Practice - Nonwing - 4' Bar	1	1
Panels - To be used with Wing and Nonwing Jumps above - 4'	1	1
FAST/Gamblers Markers	1	1
<i>Note: One Tire jump, 10 non-wing, 10 wing, 1 Double &amp; 1 Triple also have 14" jump cups</i>		
<b>All equipment and accessories (tunnel holders, etc.) provided with the exception of timing equipment, measuring wheels, a measuring device and a 3 lb weight for measuring the teeter. Non residue tape, non-residue double sided tape and Gamblers/FAST tape are available for purchase (duct tape is not allowed in the building).</b>		
<b>Tape available for purchase from The Event Center:</b>		
1 inch wide blue Painter's tape - \$6 per roll - eg defining crating areas on vinyl floor		
3 inch wide blue Painter's tape - \$20 per roll - eg taping down plastic drop cloths		
2 inch double-sided tape - \$20 per roll - eg to secure weave poles in the center if needed		
1 inch wide white Gaffer's Tape - \$10 per roll - eg Gamblers/FAST lines on Synthetic Turf		
2 inch wide gray Gaffer's Tape - \$20 per roll - eg tape down rubber matting		

LARGE  
CONFERENCE ROOM  
25 X 25

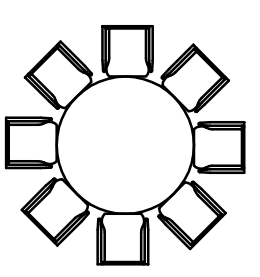
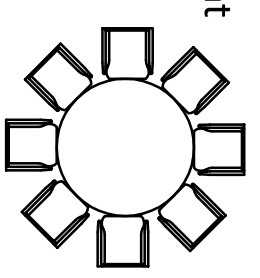
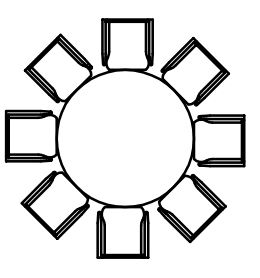
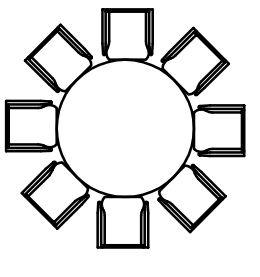

Capacity 460  
(Accommodates 320 people seated at  
banquet tables of 10)  
AV Equipment - Projector, Screen,  
Lectern and Microphones

FOUNDER'S ROOM  
80 X 75

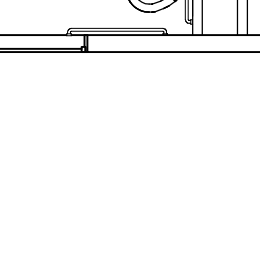
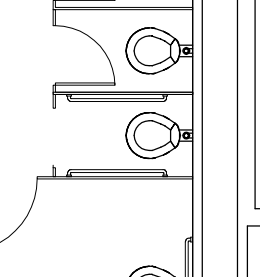
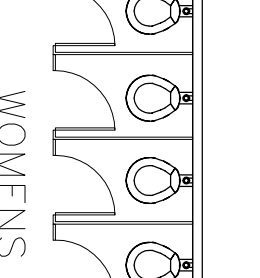
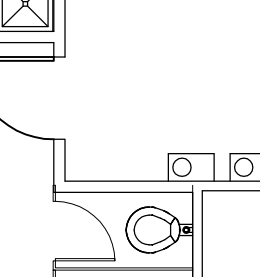
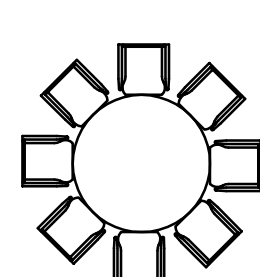
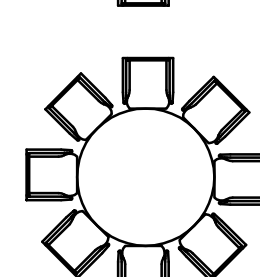
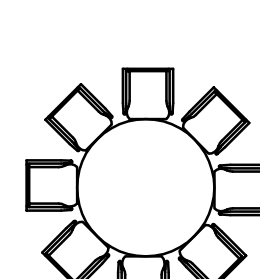
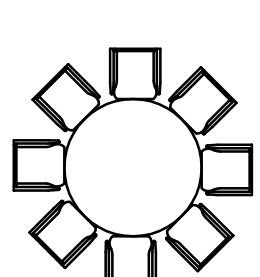
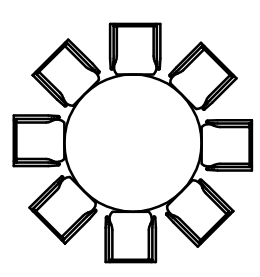
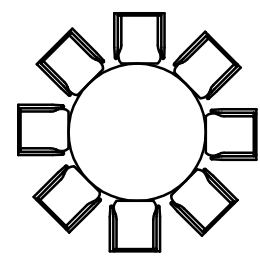
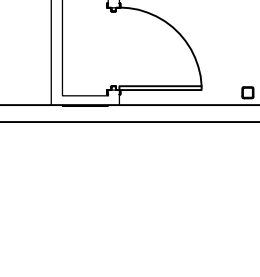
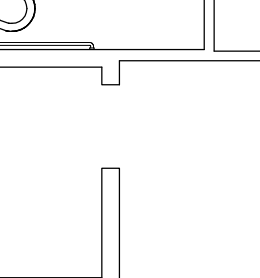
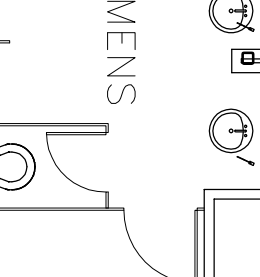
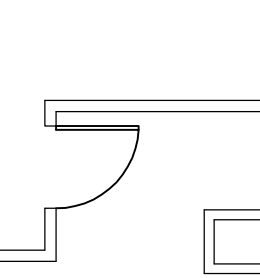
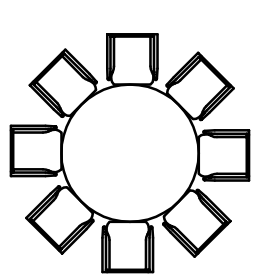
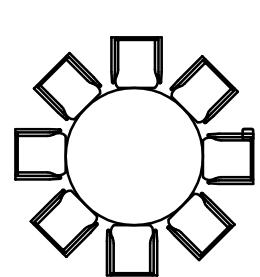
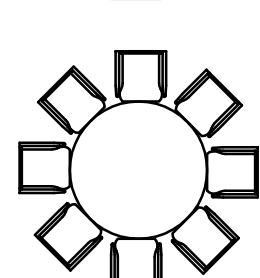
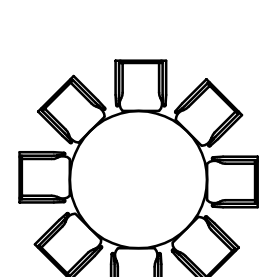
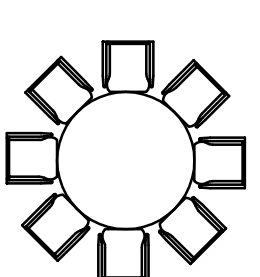
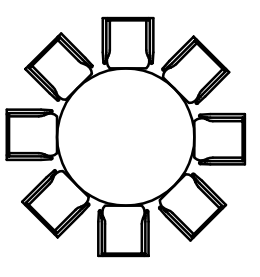
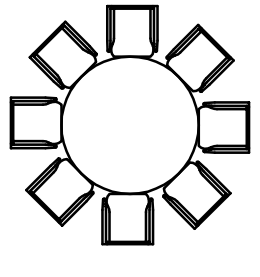
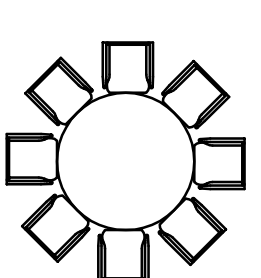
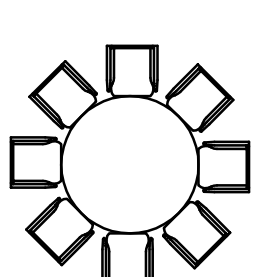
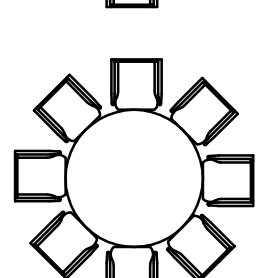
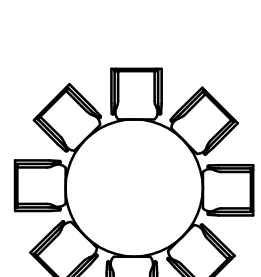
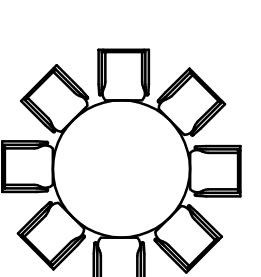
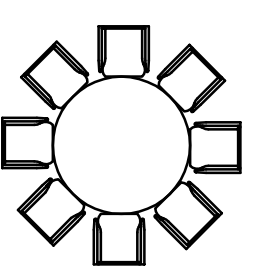
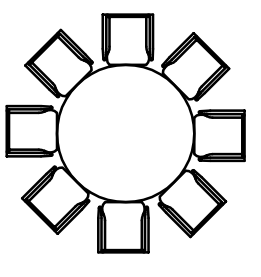
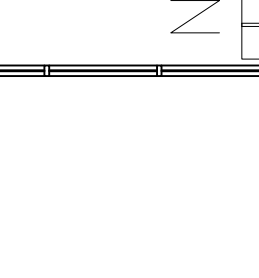
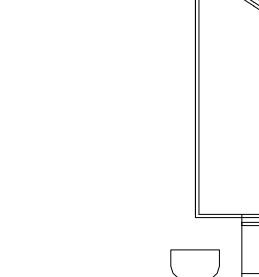
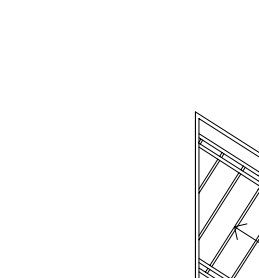
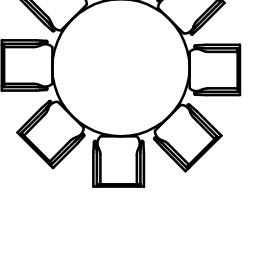
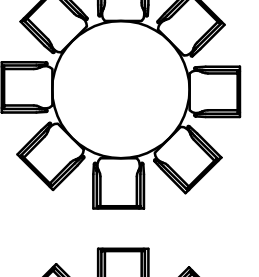
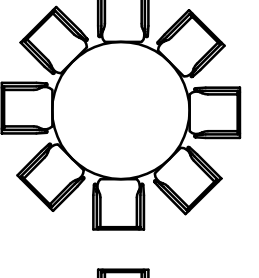
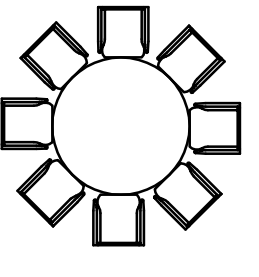
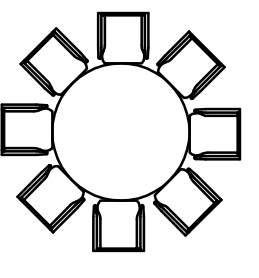
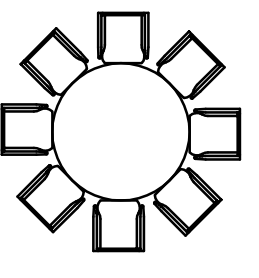
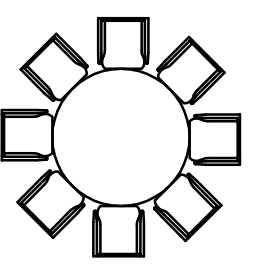
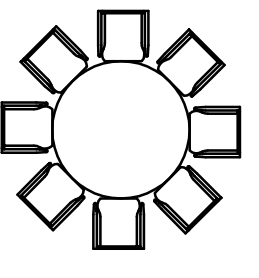

STORAGE

BACK  
STAIRWAY  
DN

VIEWING  
BALCONY

ADMIN  
OFFICE

ADMIN  
OFFICE

MENS

WOMENS

DN



EVENT CENTER  
←

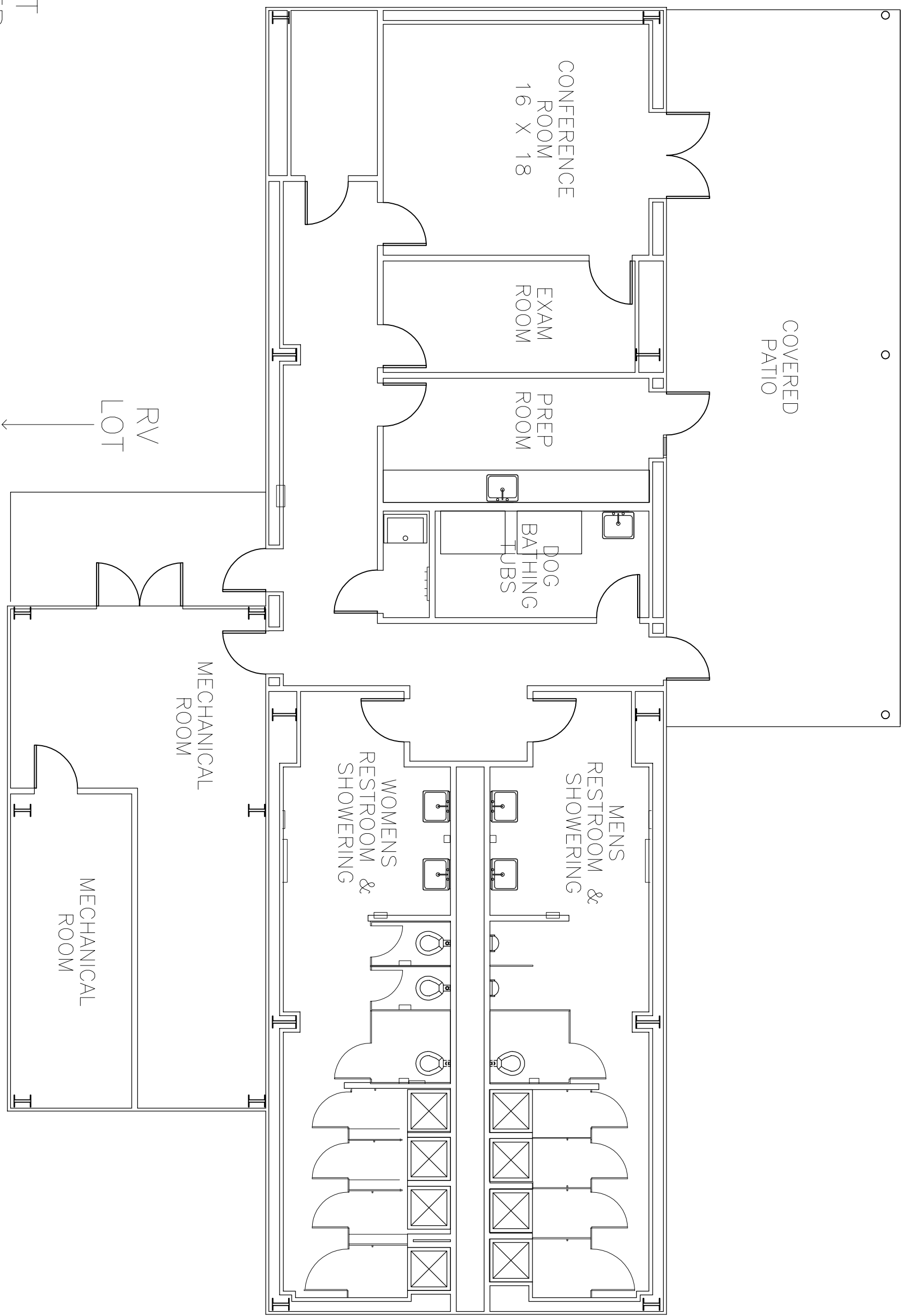

# Purina Event Center

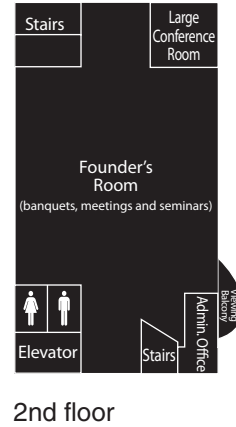
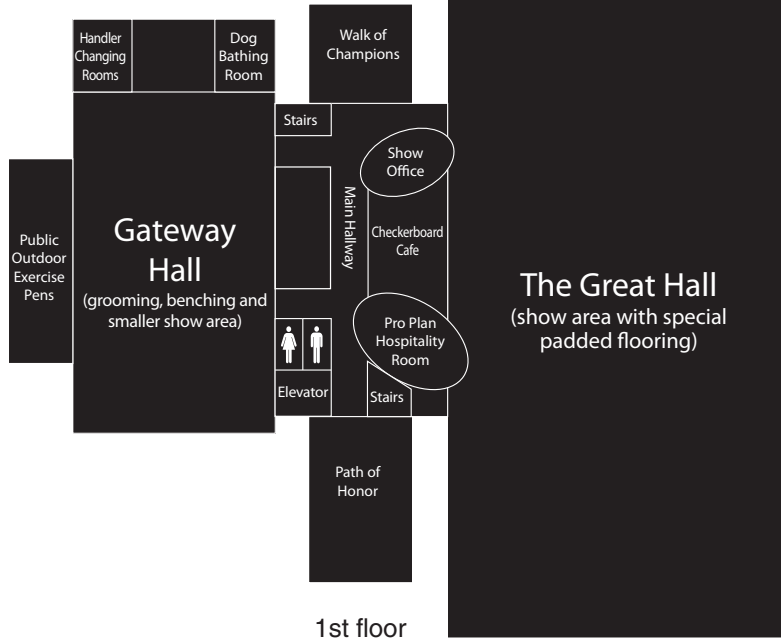

Diagrams not to scale. See dimensions below.

## Service Center

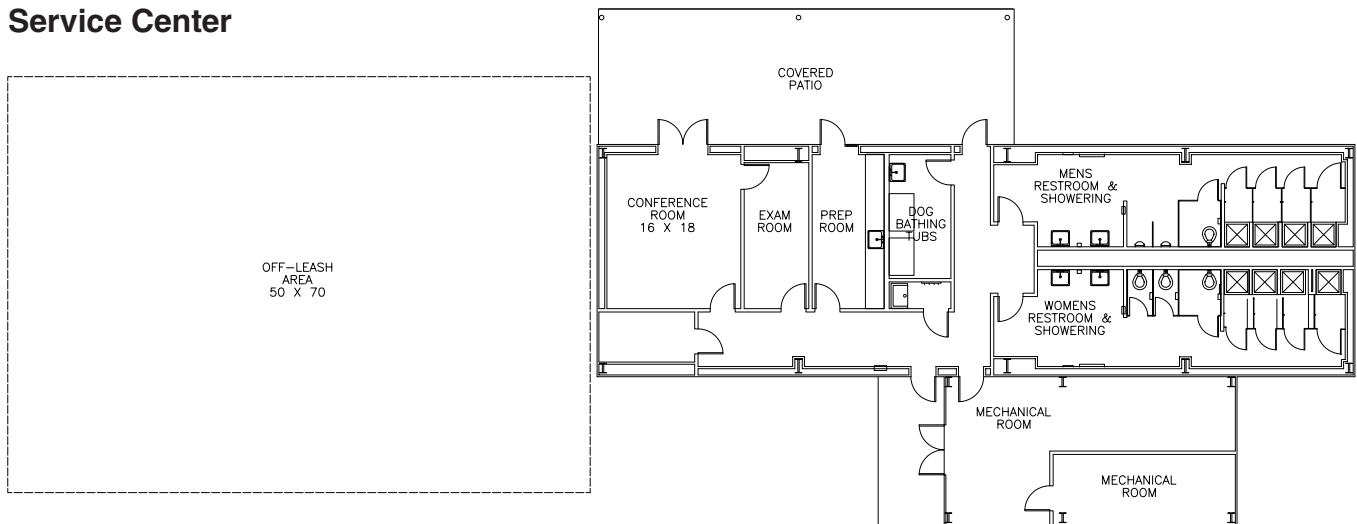

	Dimensions	Square feet	Seating	Capacity	Amenities
The Great Hall	300x150	45,000	N/A	2200	PA system
The Gateway Hall	150x90	13,500	N/A	1315	PA system
The Founder's Room	80x75	N/A	Banquet - 320 Theater - 420	460	Full AV equipment - projector, audio, laptop hook ups, screen
Large Conference Room	25x25	N/A	Boardroom - 20 Classroom - 45	N/A	whiteboard
Service Center Conference Room	16x18	N/A	Boardroom - 12	N/A	rolling whiteboard
Checkerboard Café	30x80	N/A	64	102	N/A
Pro Plan Hospitality Room	N/A	N/A	40	N/A	television monitor

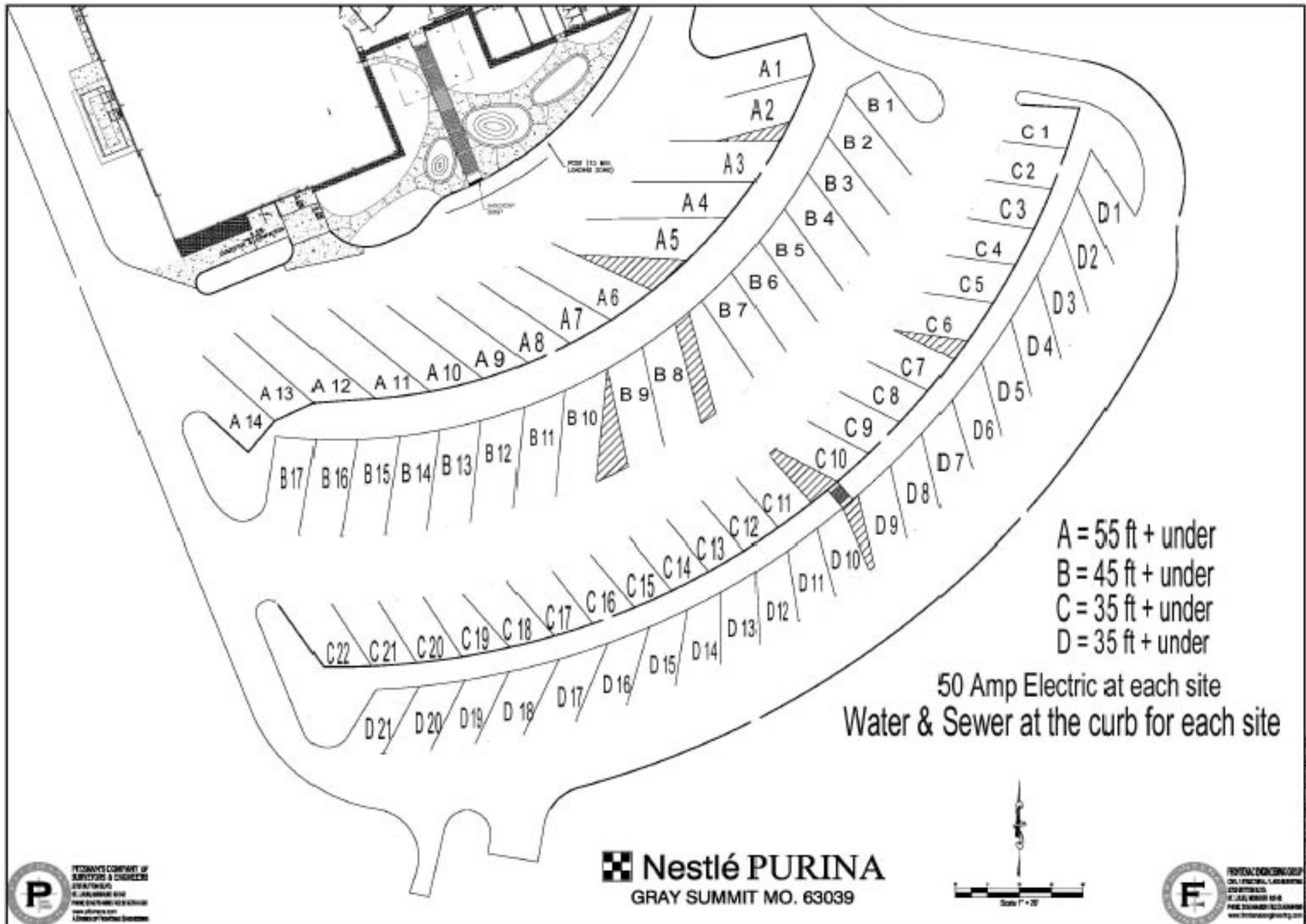

**Nestlé PURINA**  
 GRAY SUMMIT MO. 63039

## PURINA EVENT CENTER RULES

- Building Hours
  - Regular building hours are 6a.m.- 6p.m. unless otherwise noted and coordinated with the Purina Farms staff. Any non-catered events running beyond 6p.m. will be charged \$25/hour for staffing.
  - No events may take place on designated set-up and move-out days or else facility rental fees will be assessed.
- Clean-up
  - \$200 will be assessed on the final event day if the facility and grounds require excessive cleaning according to checklist that will be reviewed by both the staff and a Club official.
  - Exhibitors are responsible for cleaning up after their dogs. This includes properly disposing of waste and using designated relief areas and the public x-pen area on the East side of the Gateway Hall for all elimination needs.
  - Designated stations throughout the facility should be used appropriately (i.e. watering station should not be used for waste or other materials)
- Full-service RV spots are \$25 per space.
  - A Club can charge more if desired. If possible, Club will issue one check to Purina Farms for all of the RV parking.
  - Clubs must coordinate reserved RV parking ahead of time and provide Purina Farms with a list at least 1 week prior to the event. Clubs must also handle the parking of RVs or request at least 2 weeks ahead of time that Purina Farms staff manages it.
  - Show grounds open at noon or 3p.m. on the designated set-up day for the event depending on what is reflected in the Club contract. Any RVs arriving before that time will have to wait behind the main security gate.
  - Only cars (max of 2) affiliated with the RVs parked in the spots will be allowed to park in the same spot in the RV lot. Any cars not affiliated with the RVs in the spots will be asked to move or be towed at the owner's expense.
- Grooming spots are free and include 10-20 amps of electric service per assigned space.
  - Clubs can charge per space if desired.
  - If grooming is going to take place, then the Gateway Hall needs to be rented. When the Gateway Hall spots are all taken, then additional spaces in the Great Hall can be considered. Only overflow grooming is allowed in The Great Hall.
  - If grooming is taking place in The Great Hall, then 4mil plastic must be provided by the Club (and can be purchased from Purina Farms) to cover the floor. Painter's tape can be used to keep the plastic down.
  - Club must assess grooming tables being used in The Great Hall and provide exhibitors with rubber caps for the tables (Purina Farms will provide) if they appear like they will damage the flooring.
- Payment
  - Please know that security and food service will be billed separately from the rental fees, entry fees and other misc. Show charges. You will receive one bill for your building rental charges and associated entry/run fees, as well as any other

“extras”, where a check can be made payable to Purina Farms. If you hire security through Purina, then you will be billed and the check needs to be made payable to Nestle Purina PetCare company. All of your food service will be billed after the Show and sent to you via mail.

- All food and beverages\*
  - Need to be purchased through the on-site food service and catering company.
  - No outside food or beverage, or outside food service/catering company, is allowed on the Purina Farms property (\* unless Club receives written permission from the Director of Purina Farms)
  - Only bottled water is allowed to be brought in for judges and workers only
- Security and overnight crating is at the Club’s discretion\*
  - If overnight crating in the Gateway Hall is allowed, the Club must work with Purina Farms to provide security (9 or 10p.m. – 6a.m. the next morning). Two weeks notice to Purina Farms is required in order to schedule security. Security is charged at a flat rate of \$25 per hour.
- Photo Set-up
  - The official Show photographer must clearly display the Purina Event Center logo in every photo whether it is represented on the Show podium, backdrop or portable stand provided by Purina Farms. The logo must be visible in its entirety.

**\*All All-Breed Shows must provide overnight security from 10p.m. – 6a.m.**

- No exercise pens allowed around the front of the Purina Event Center and exercise pens around the perimeter of the entire building are strongly discouraged.
- All veterinary exams, tests, and medical procedures must take place only in the Service Center.
- The Club and/or the Show Superintendent must provide Purina Farms staff with official entry numbers on the last day of the Show.
- Crating in The Great Hall is discouraged due to noise distractions, but ultimately, it is up to the Club to allow it or not. It will not be dictated or enforced by Purina Farms.
- No dogs are allowed, except for service dogs:
  - In the Checkerboard Café, on the second floor of the Purina Event Center and in any restroom or human bathing area.
- All dogs are required to be on-leash at Purina Farms at all times (except when crated or as required to be judged)
- No parking is allowed in the following areas.
  - Fire lanes, inside either Hall (No vehicles are allowed to drive inside either hall) or on the sidewalks leading into either Hall except where loading and unloading is designated. In addition, no driving is allowed on sidewalks.
- All exhibitors must abide by the 15-minute unloading/loading parking time limit designated around the Purina Event Center
- No swimming (dogs and people) allowed in any ponds on the property
- All exhibitors and their dogs must remain on the part of the property owned by Purina Farms. Trespassing on Land O’ Lakes/Longview Animal Nutrition Center property is forbidden.

- Children under the age of 12 must be accompanied by an adult, when on the grounds (including Purina Farms Visitor's Center).
- Exhibitors accept personal liability with respect to any claim made in respect to any damage or injury caused by their dog/s or dogs in their possession.
- In case of a medical emergency in the RV lot in the evening or after hours, exhibitors needing medical attention should leave the lights on their RVs allowing the response team to easily identify the appropriate vehicle.
- The club storage key must be signed in and out from Brock Fitzgerald or Kaite Flamm.
- No selling of puppies or dogs on the premises.

Special Notes: Purina Event Center staff reserves the right to refuse entry to any party/person or animal and retains the right to remove any person or persons and/or any animal from the premises in order to ensure the safety of any and all visitors and dogs. Exhibitors indemnify Purina, the affiliated person/s or businesses conducting the Show or Trial, against any and all claims of arising that may be leveled against them, jointly or severally, in respect to any damage, injury or loss to persons, pets and/or property.

#### Incllement Weather

In the event a severe weather or tornado warning is issued for the immediate area, Site Security will notify the Purina Farms management team. The team will notify guests, participants and exhibitors of an impending weather event via the public address system inside the building and via the storm siren and announcements outside the building. Guests, visitors and exhibitors will be asked to seek cover in place in designated areas. Designated areas to seek cover, marked as severe weather shelter areas, include the center hallway of the Purina Event Center and the inside wall of Gateway Hall. After the weather event ends, Purina Farms management teams will announce all clear.

#### **Important Contact Numbers**

Purina Farms Security 636-221-1428  
 Boles Fire Protection District 636-742-2313  
 Meramec Ambulance District 636-257-3048  
 Washington Veterinary Clinic, Dr. John Stoltz 636-239-5445  
 Pacific Animal Hospital (24 hours) 636-257-2100  
 Franklin County Sheriff Department 636-583-2560  
 St. John's Mercy Hospital 636-239-8000

#### **RULES FOR OVERNIGHT GUESTS**

Welcome to Purina Farms. We want your experience here to be as enjoyable as possible. To help ensure this, we ask that all visitors conduct themselves in a courteous and respectful manner in and out of the show ring. For your dogs' safety, they should be leashed or crated unless competing in an event.

All RV exhibitors are asked to check-in upon their arrival with a club member and/or Purina representative. Camping is only allowed in the designated RV areas on the property. Advanced arrangements need to be made to overnight at the facility past the last day of the event you're attending. As good neighbors, please keep all equipment, extra cars (max of 2), etc. in your assigned area and dispose of all trash in receptacles provided. For safety reasons no campfires are allowed. Purina Farms is a "family friendly" facility and public intoxication is prohibited.

Cars, vans and RV's are only allowed on designated roadways and parking areas. Other motorized vehicles are not allowed on premise with the exception of wheelchairs and golf carts for handicapped exhibitors.

We ask that you stay within the designated show site, which is within 100 yards of the Purina Event Center. Please no smoking in and around buildings. No hunting or swimming is allowed. Weapons of any kind, illegal drugs and fireworks are not permitted on the premises. Enjoy your stay!

**Purina is not responsible for any damage, injury or loss to persons, pets and/or property.**



AMERICAN  
KENNEL CLUB™

# MEMORANDUM

March 4, 1998

**TO:** *All AKC Clubs  
All Superintendents*

**SUBJECT:** *Emergency Procedures at Dog Events*

At its November 1997 meeting, the Board of Directors considered the report of the Delegate Dog Show Rules Committee on the subject of Emergency Care at Events. The Board adopted the following policy, which will apply to events held on or after January 1, 1999:

## **EMERGENCY PROCEDURES AT DOG EVENTS**

1. Each club holding a member or licensed event must develop and detail a *Disaster and Emergency Plan* for that event. The Plan form must be completed and filed with AKC and will be considered a part of the event application.
2. Clubs must advise local authorities (police, fire department, medical services, etc.) of their event, including the exact location, ingress, egress and duration, within thirty days prior to the event.
3. All clubs are strongly encouraged to have a qualified emergency medical technician (CPR certified) in attendance at each event.
4. At group and all-breed conformation events, clubs are required to have a qualified emergency medical technician (CPR certified) in attendance from one hour prior to the start of judging until completion of all judging.
5. A Red Cross-approved emergency first aid kit must be available at all events.
6. Emergency care at all events must also comply with local community standards.
7. Personnel will be on duty after show hours at show sites where dogs are left overnight.
8. At least one working cellular telephone is required to be on the show grounds during show hours.

### **The Disaster and Emergency Plan**

The committee feels strongly that the attached Plan contains the necessary information for an event-giving club to react to any emergency or disaster in a timely manner. **An Evacuation Plan, (Diagram), for indoor facilities, should be displayed in all prominent, high traffic areas.** The Board feels that completion of the Plan form will require an event committee to put the necessary forethought into dealing with an emergency or disaster. The Board does not anticipate that AKC will evaluate the accuracy of the Plan, any more than site plans or site contracts are typically evaluated for accuracy before an event. It is felt that event-giving clubs will put the effort into development of the Plan to ensure its adequacy and accuracy.

The event-giving club would also be responsible for providing multiple copies of the Plan at the event. Additionally, in order to make the Plan available to all participants of an event, clubs may print information in the event catalog and judging program.

### **Definition – Event**

For the purposes of this policy, an event is defined as a show given by a club or association that is a member of, or licensed by, the American Kennel Club, at which championship points are awarded; or a trial or test given by a club or association that is a member of, or licensed by, the American Kennel Club, at which qualifying scores towards titles are awarded.

**Effective Date: January 1, 1999**

(EVENT OPERATIONS)



AMERICAN  
KENNEL CLUB™

# Disaster and Emergency Plan

www.akc.org

Name of Club: \_\_\_\_\_

Exact Location of Event: \_\_\_\_\_

Date of Event: \_\_\_\_\_ Type of Event: \_\_\_\_\_

Adequate provisions for individual emergency situations and for sudden mass disasters for both dogs and people must be a part of planning every American Kennel Club event. **No AKC event will be approved unless such plans are in place. Written Procedures for the following should be available at your event:**

### Emergency Plan for Dogs

**Emergency Plan for People: Evacuation Plan, (Diagram) Posted in High Traffic Areas, For Indoor Facilities**

**Mass Disaster Plan**

**Security Personnel**

### SECURITY PERSONNEL:

List Names, Telephone Numbers (and Addresses where requested) for the following:

**Ambulance Service:** Meramec Ambulance District

Phone: ( 636 ) 257-3048 or 911 for Emergency  
 On Site     On Call

### **Washington Veterinary Clinic, Dr. John Stoltz**

**Veterinarian:** Pacific Animal Hospital (24 hr emergency care) - 450 West Flier Drive, Pacific, MO 63069

Phone: ( 636 ) 239-5445 or (PAH - 636-257-2100)  
 On Site     On Call

**Fire Department:** Boles Fire Protection District

Phone: ( 636 ) 742-2313 or 911 for Emergency

**Police Department:** Franklin County Sheriff Department

Phone: ( 636 ) 583-2560 or 911 for Emergency

(EVENT OPERATIONS)

**Hospital:** St. John's Mercy Hospital

Phone: ( 636 ) 239-8000

Address: 901 E. 5<sup>th</sup> St.

Washington, MO 63090

**Show Chairman (must be a club member):** \_\_\_\_\_

Address: \_\_\_\_\_

Daytime Phone: ( \_\_\_\_\_ ) \_\_\_\_\_

Evening Phone: ( \_\_\_\_\_ ) \_\_\_\_\_

**Emergency Response Coordinator (must be a club member):** \_\_\_\_\_

Address: \_\_\_\_\_

Daytime Phone: ( \_\_\_\_\_ ) \_\_\_\_\_

Evening Phone: ( \_\_\_\_\_ ) \_\_\_\_\_

**Name of Club Officer Submitting Form:** \_\_\_\_\_

**Signature:** \_\_\_\_\_ **Date:** \_\_\_\_\_

**Return Form To:**  
The American Kennel Club  
Event Operations Department  
PO Box 37929  
Raleigh, NC 27627-7929  
Fax (919) 816-4215

<b>Outdoor Canine Competition Venues (7)</b>			
Main Show Field (130' x 140')			
	2 show and 1 grooming tents (40x80)		
	White ring gating with red standards		
	Vendor area		
	Club Pavilion		
	Food Pavilion		
<i>2 additional fields in the Main Show Field area</i>			
	Field next to billboard is a flat 80x115 area		
	Lower field below Main Show Field is a flat 120x120		
Agility Field (across from the Incredible Dog Arena) (100' x 110')			
	22x45 ft pavilion		
	Full set of agility equipment		
	Ring gating		
	(Note: No lighting)		
Herding & Trial Field (entrance from MM)			
	A course approximately 100x200 ft lighted		
	B-Course approximately 10 acres with holding pens		
	Lighted round pen for beginning dogs and instinct testing		
	150 Katahdin Crossbred sheep		
	Holding pens for each competition area		
	Field also used for Lure Coursing		
	2 - 10x20 tents and 6 - 10x10 tents		
Tracking & Lure Coursing Field			
	25+ acres for activity		
	Accommodates small tracing competitions		
Working Dog & Flying Disc Competition Field (west side of the Purina Event Center)			
	160x440 ft flat area for competition		
Go To Ground Dens			
	Permanent dens for all levels		
Diving Dog at the Incredible Dog Arena			
	18'x 50'x (4'deep)in-ground, heated diving dog pool with a ramp is 8' wide x 45' long.		
	Permanent bleachers for 300 spectators		
	Completely lighted with professional sound system		



## Lodging

There are more than 600 hotel rooms that accept pets within 15 minutes of Purina Farms. The closest, Travelodge Diamond Inn, has 168 rooms at ground level. The largest, Holiday Inn at Six Flags, has 188 rooms with most at ground level. DUE TO CHANGES IN SOME HOTEL & MOTEL POLICIES, BE SURE TO CHECK WITH THE HOTEL/MOTEL OF YOUR CHOICE TO SEE IF THEY STILL ACCEPT DOGS

### HOTELS & MOTELS THAT WILL ACCEPT DOGS

#### **Holiday Inn**

(800) 782-8108 or (636) 938-6661  
I-44 & Allenton Rd, 4901 Six Flags Road, Eureka MO 63025  
\$30.00 pet fee • Indoor Pool, Fun Dome & Restaurants  
10 miles East of Purina Farms

#### **Travelodge Diamond Inn**

(800) 782-8487 or (636) 742-3501  
581 Hwy 100 E & Gray Summit Exit, Villa Ridge MO 63089  
\$25.00 one time pet fee, non-refundable • INCLUDES ANY DOGS ON PROPERTY

#### **Eureka Super 8**

(636) 938-4368  
1733 W 5th St, Eureka MO 63025  
\$10.00 per day non-refundable pet charge • Pool & Game Room • 10 miles East of Purina Farms

#### **Motel 6**

(636) 587-7000  
15 Hilltop Village Center Drive  
Eureka, MO 63025  
10 miles East of Purina Farms

#### **Econo Lodge Inn at Six Flags**

(800) 251-1962 or (636) 938-5348  
1725 W 5th St, Eureka MO 63025  
\$10.00 per dog per night • Pool & Mini Golf • 10 miles East of Purina Farms

#### **Budget Lodging**

(636) 629-1000  
866 S I-44 Outer Rd, St Clair MO 63077  
\$5.00 per pet fee • 13 miles West of Purina Farms

#### **Drury Inn**

(636) 343-7822  
I-44 & Bowles Ave, 1088 South Highway Drive, Fenton MO 63026  
30 miles East of Purina Farms

#### **Pear Tree Inn**

(636) 343-8820  
I-44 & Bowles Ave, 1100 S Highway Dr, Fenton MO 63026  
30 miles East of Purina Farms

#### **Sleep Inn**

(636) 390-3264  
2621 East Fifth Street, Washington, MO 63090  
20 miles West of Purina Farms

#### **Wildwood Town Center Hotel**

(636) 733-9100  
2801 Fountain Place, Wildwood, MO 63040  
15 miles North of Purina Farms

#### **Comfort Inn**

(636) 257-4600  
1320 Thornton St., Pacific MO 63069  
5 miles East of Purina Farms

#### **Quality Inn**

(636) 257-8400  
1400 West Osage St., Pacific MO 63069  
5 miles East of Purina Farms

### CAMPGROUNDS THAT WILL ACCEPT DOGS

#### **Jellystone Park**

(636) 938-5925  
10 miles East of Purina Farms

#### **KOA Campground**

(636) 257-3018  
Old Rt 66 - 10 miles East of Purina Farms

#### **Pin Oak Creek**

(636) 451-5656  
4 Miles South of Show Site

#### **Robertsville State Park**

(636) 257-3788  
10 miles South of Purina Farms

Purina Farms Added Amenities		
	Company	
Security	Nestle Purina PetCare	
Pine Shavings	Upon request through NPPC	
RV with pick up and drop off charges	Byerly	(800) 878-3325
Golf cart rental	Gateway Golf Cars	(636) 272-2278
AV equipment, stage, pipe & drape, etc..	Weinhardt	(314) 822-9000
Bleachers	Ace Rentals (also have tables, stage, fans, etc.)	(314) 771-7222
Flowers	Coleman Florist in Pacific, MO	(636)271-2436
Rental Cars	Enterprise in Eureka	(636) 587-2834
Portable Electric (generator)	Fabick CAT - Upon request through Purina Farms	(636) 349-5500
Additional dumpsters	Upon request through Purina Farms	
Tents	Event Partners - Upon request through Purina Farms	(314)729-7776
<i>40'x120' pole tent (4,800 sq ft) = \$ 2,080</i>		
<i>40'x120' frame tent (4,800 sq ft) = \$2,680</i>		
<i>50'x100' frame tent (5,000 sq ft) = \$3,880</i>		
<i>60'x80' twin pole tent (4,800 sq ft) = \$2,680</i>		
Outdoor portable lighting	K&K Supply - Upon request through Purina Farms	
Gaffer's Tape (agility) - 2 inch wide - gray	\$20 per roll	
Gaffer's Tape (agility) - 1 inch wide - white	\$10 per roll through Purina Farms	
Double-sided tape	\$20 per roll	
4 mil plastic for grooming (10x100 and 20x100 available)	Upon request through Purina Farms	
Painter's Tape (1 inch and 3 inches)	Upon request through Purina Farms	

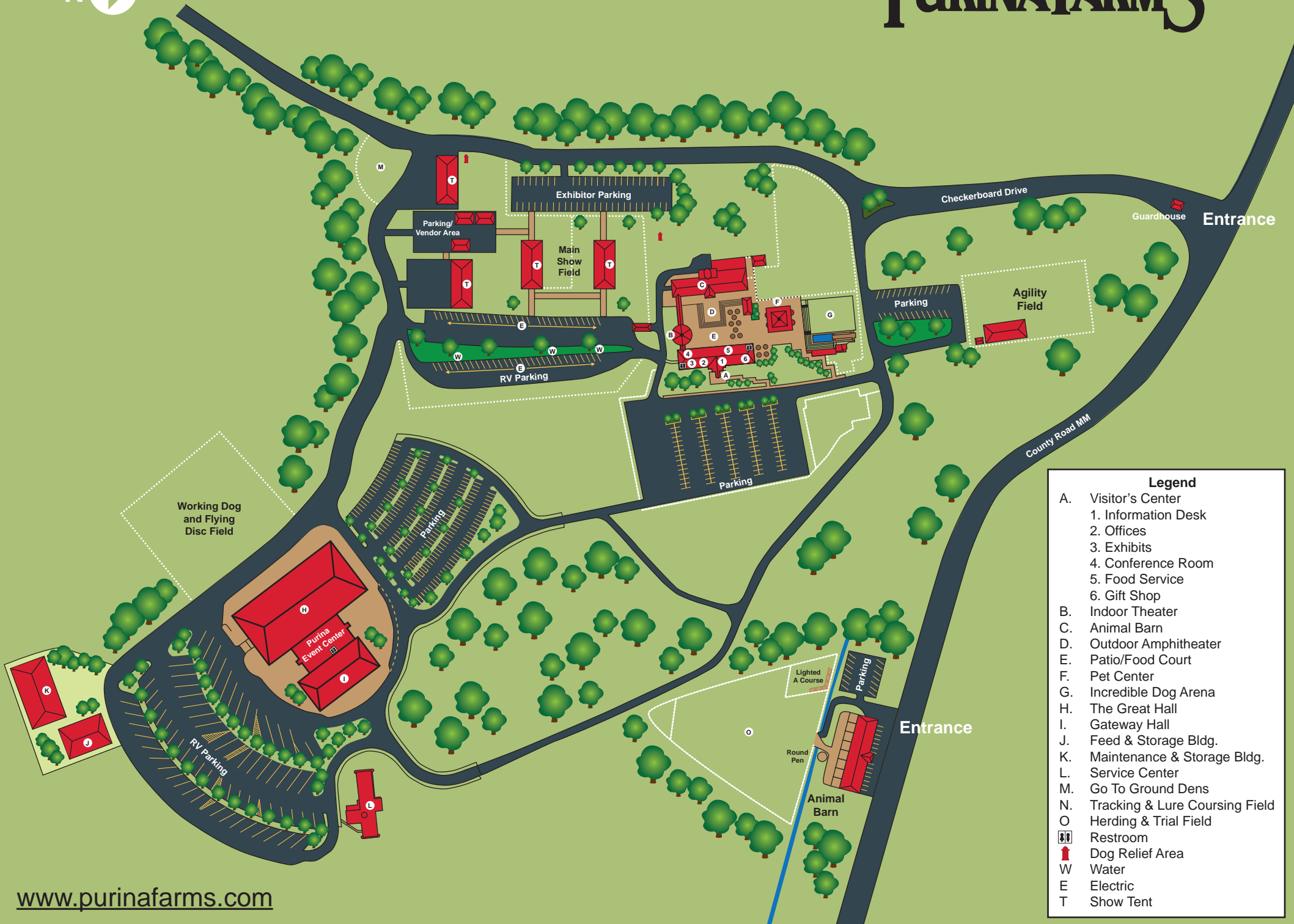

Legend	
A.	Visitor's Center
1.	Information Desk
2.	Offices
3.	Exhibits
4.	Conference Room
5.	Food Service
6.	Gift Shop
B.	Indoor Theater
C.	Animal Barn
D.	Outdoor Amphitheater
E.	Patio/Food Court
F.	Pet Center
G.	Incredible Dog Arena
H.	The Great Hall
I.	Gateway Hall
J.	Feed & Storage Bldg.
K.	Maintenance & Storage Bldg.
L.	Service Center
M.	Go To Ground Dens
N.	Tracking & Lure Coursing Field
O.	Herding & Trial Field
	Restroom
	Dog Relief Area
W	Water
E	Electric
T	Show Tent

## **Purina Event Center Checklist for Shows**

### Building Hours

- What time would you like the building open until each night?

(Normal building hours are 6a.m. to 6p.m. unless requested later. Staffing charges apply for any non-catered events/activities going past 6p.m.)

- What are the actual hours of your Show in case the general public wants to come out and be spectators?

### Front Entrance Gate to Purina Farms

- What hours for the front entrance gate to the Farms?
- Do you want it open later than 6p.m. to allow exhibitors/campers to go in and out?  
*Anyone arriving after hours can call Purina Farms security to open the gate – 636-221-1428*

### Cafe

- What hours would you like the café open each day?

*(Normally, it is open 8a.m. – 4p.m., but it can be open earlier for breakfast (7a.m. or 7:30a.m.) and stay open later (5p.m. or later as agreed upon with Food Service Consultants) if you want)*

*Note: There are also soda, water and snack vending machines in the Gateway Hall.*

### Layout

- How many rings will you need and what sizes?

### Overnight crating

- Are you allowing dogs to stay in the building overnight?
- If so, what nights?

*The charge is \$200 each night to have security in the building if you allow the dogs to stay in the building. (Hours for overnight security are 10p.m. – 6a.m.)*

### RV

- What date and times will you be allowing campers to come onto the property (note: they can't come in before noon on your designated set-up day)?
- Please provide us with an emergency contact from your Club who will be staying in the RV lot (name and cell phone)
- Based on the layout of our RV lot, some campers might need to bring longer hoses in order to hook-up. If they need to buy some when they get on-site, they can contact Byerly RV in Eureka, MO (about 10 minutes away) at 800-878-3325

### Equipment

- Easels (8 available) – how many?
- Chairs (200 available) – how many?
- 6' plastic tables (45 available) – how many?
- Smaller grooming size ring tables (11 available) – how many?
- Portable sound system for The Great Hall – Y or N
- Ring Numbers – Y or N                      What numbers (1-12)?
- Pipe & Drape (\$10 cleaning fee per 10 ft section used) – Y or N              How many feet?
- What performance equipment will you need (obedience, rally and agility)?

### Monitors

- We have 2 monitors in the Main Hallway of the Purina Event Center that can run your schedule of events. In order to have a presentation on the monitors, we would need the following from the Club:
  - A document created in word for each slide that you want in the presentation
  - Delivered to Kaite Flamm at least 3 weeks prior to the start of the Show. If received after that point, then it won't be shown on the monitors.
  - Samples from other Clubs can be provided upon request

### Grooming

- Are you going to allow grooming in The Great Hall (note: it is only allowed after the Gateway Hall spots are all reserved. The Great Hall is overflow only)? Y or N      If yes, how many spots?
- Are you bringing your own 4 mil plastic and painter's tape to put down or are you purchasing it from Purina (you must have plastic down to groom in The Great Hall)?

*(Purina pricing: \$40 for a 10x100 roll of plastic and \$20 for a 3in roll of painter's tape – normally takes 5-6 rolls of plastic and 1 roll of tape to cover South end of The Great Hall for grooming)*

### Special Events

- Dates and times of meetings/banquets/seminars in the Founder's Room (see meeting space sheet for capacity and amenities)?
- Dates and times of meetings/banquets/seminars in the Large Conference Room (see meeting space sheet for capacity and amenities)?
- Judges hospitality (large conference room) – Y or N

### Vendors

- Would you like a copy of the Purina Farms vendor list?
- How many vendors will you have? How many will need electric?
- Please ask vendors NOT TO SHIP any boxes to the Purina Event Center prior to the Show as we don't have the storage space for vendor shipments

- Note: The Purina Event Center has a total of 45 tables that are available for Club use. It is up to the Club if you would like to provide vendors with some of the tables. *(If not, they should bring their own being mindful though of the special flooring at the Purina Event Center and making sure the tables/chairs won't leave an indentation or mark on the floor)*

#### Outdoor Canine Competition Venues

- What venues will you be utilizing and what days?
  - Main Show Field
  - Outdoor Agility Field
  - Herding & Trial Field
  - Go To Ground Dens
  - Working Dog & Flying Disc Field
  - Incredible Dog Arena for diving dog (only available in late afternoon/evening)
  - Tracking or Back Lure Coursing Field

#### Service Center

- Will you be hosting any health clinics? If so, which ones and on what days?

*(All veterinary checks and health exams need to be performed in the exam room in the Service Center building)*

#### Other Notes

- Free Wi-Fi is available under "guest" in the Purina Event Center and the RV lot
- There is no ATM on the property